



Screwdriving Technology



Automation



Air Motors



Air Tools



Straight Grinders

Vane Motor / Turbine Drive

Power Output: 1,2 - 2,8 kW (1.6 -3.8 HP)

- optimum power-to-weight ratio
- robust
- highly durable
- simple operation
- ergonomic

Our air straight grinders are used with flat/cutting-off/tapered grinding disks, wherever heavy-duty fabrication is required on steel and castings or when deburring welding-, casting-, and ridge-seams. It has never been easier to perform smooth or coarse grinding of steel & cast iron in foundries, or when polishing welding seams or when fabricating casted parts.

Our straight grinders can also be used with steel brushes for the removal of rust or when descaling rolled steel and forgings.



THE BEST TOOLS FOR EFFICIENT MATERIAL REMOVAL

Optimum power-to-weight ratio

Straight grinders are characterized with keeping the speed of the tool constant, even if tool is operated at maximum. Motor construction uses modern materials and production technology to achieve power maximum of 2,8 kW. Power output of the Turbine Grinder: The already high power-to-weight ratio of our standard air-grinders is surpassed by our grinders equipped with turbine motors.

Robust

Our robust straight grinders are designed for the using in heavy-duty fabrication (foundries, quarries, buildings, engineering).

Highly durable

The robust design of the straight grinders assures a long life span - even when the tool is under continued operation.

Simple operation

Our Grinders are reliable and assure a simple operation and ease of maintenance. The straight grinders operate at an extreme low noise-level. The ergonomic design of the tool-grip reduces the machine's vibration.

Oil-free operation

For an oil-free operation, we offer our special line of turbine grinders.



TYPE KEY

GS T 815 - 220 B X A E O

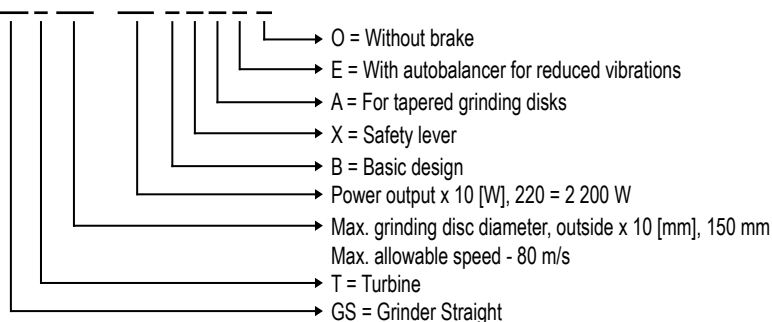

SPECIFICATIONS - STRAIGHT GRINDERS WITH VANE MOTORS

Straight grinders with vane motor

- for the fabrications on steel, for the deburring of welding-, casting-, and ridge-seams (with grinding disks)

- for the removal of rust, the descaling of rolled steel and forgings (with steel brushes)

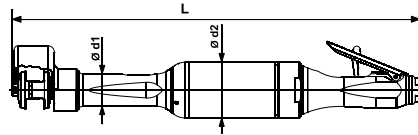

GS 508-120BXA

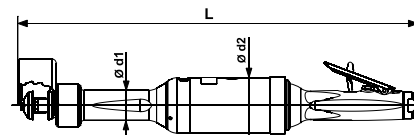

GS 510-230BX

| For flat grinding disks | Model Part No. | GS508-120BX 6061228A | GS510-230BX 6061289A |
|--------------------------------|---------------------------|-------------------------|-------------------------|
| For tapered grinding disks | Model Part No. | GS508-120BX 6061228B | - |
| Speed (no load) | min ⁻¹ (rpm) | 12 000 | 9 500 |
| Max. power output | kW (hp) | 1,2 (1.61) | 2,3 (3.08) |
| Air consumption (loaded) | m ³ /min (cfm) | 1,2 (42.37) | 2,2 (77.68) |
| Air consumption (no load) | m ³ /min (cfm) | 0,65 (22.96) | 0,7 (24.72) |
| I.D. of air inlet hose | mm (in) | 13 (.51) | 16 (.63) |
| Grinding disk-Ø outside | mm (in) | 80 (3") | 100 (4") |
| Grinding disk-Ø inside | mm (in) | 20 (.79) | 20 (.79) |
| Grinding disk - clamping range | mm (in) | 20÷25 (.79÷.98) | 20÷25 (.79÷.98) |
| Max. allowable speed | m/s (ft/s) | 50 (164) | 50 (164) |
| Grinder-Ø d1/d2 | mm (in) | 36/62 (1.42/2.44) | 39/72 (1.54/2.83) |
| Grinder length L | mm (in) | 453 (17.83) | 520 (20.47) |
| Air connection | | thread 3/8" female | thread 1/2" female |
| Weight | kg (lbs) | 2,6 (5.73) | 4,0 (8.82) |

Specifications at 90 psi (6,3 bar)

* With Autobalancer for reduced vibrations

| Standard Equipment: | Part Number | |
|-------------------------|-------------|---------|
| Allen key 2 mm | 800443 | 800443 |
| Allen key 5 mm | 800448 | - |
| Allen key 6 mm | 800449 | 800449 |
| Hose nozzle G1/2"-13 mm | 6013772 | 6013772 |

| Optional Accessories: | Part Number | |
|--------------------------------------|-------------|---------|
| Plug 27SF AK17 SXN | 6074950 | - |
| Plug 27SF AK21 SXN | 6072227 | 6072227 |
| Hose nozzle, turn-able G1/2" | - | 6021377 |
| Hose nozzle, turn-able G3/8" | 6022433A | - |
| O ring | 6070103 | - |
| Swivel connector G3/8" | 816376 | - |
| Swivel connector G1/2" | - | 6078628 |
| Hose set (hose LW 13 mm, length 4 m) | - | 315130A |

Optional Accessories:

Swivel connector G1/2"
Part No. 6078628

The swivel is an ingenious multi-directional connector. Connect your tool and the hose will stay in ideal position however much you and the tool move around. It takes the effort out of working in those cramped spaces. The hose feels almost weightless and it reduces hose wear.



Set - hose 4 m, connection
Part No. 315130A



SPECIFICATIONS - STRAIGHT GRINDERS WITH VANE MOTORS

Straight grinders with vane motor

- for the fabrications on steel, for the deburring of welding-, casting-, and ridge-seams (with grinding disks)

- for the removal of rust, the descaling of rolled steel and forgings (with steel brushes)

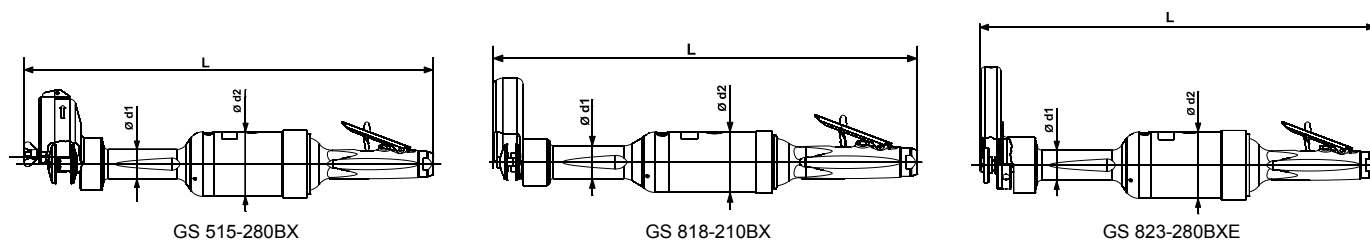

| For flat grinding disks | Model Part No. | GS315-240BX 6061141A | GS515-280BX 6061301A | - | - |
|---|---------------------------|-------------------------|-------------------------|----------------------------|---------------------------|
| For cutting-off disks | Model Part No. | - | - | GS818-210BX 6061296A | - |
| For cutting-off disks, with Autobalancer* | Model Part No. | - | - | GS818-210BXE* 6061296B | GS823-280BXE* 6061307B |
| Speed (no load) | min ⁻¹ (rpm) | 4 000 | 6 400 | 8 500 | 6 600 |
| Max. power output | kW (hp) | 2,4 (3.22) | 2,8 (3.75) | 2,1 (2.81) | 2,8 (3.75) |
| Air consumption (loaded) | m ³ /min (cfm) | 1,9 (67.09) | 2,4 (84.75) | 2,1 (74.2) | 2,4 (84.75) |
| Air consumption (no load) | m ³ /min (cfm) | 0,7 (24.72) | 0,8 (28.25) | 0,65 (23.0) | 0,8 (28.25) |
| I.D. of air inlet hose | mm (in) | 16 (.63) | 16 (.63) | 16 (.63) | 16 (.63) |
| Grinding disk-Ø outside | mm (in) | 150 (6") | 150 (6") | 180 (7") | 230 (9") |
| Grinding disk-Ø inside | mm (in) | 20 (.79) | 20 (.79) | 22,23 (.84) | 22,23 (.84) |
| Grinding disk - clamping range | mm (in) | 20÷25 (.79÷.98) | 20÷25 (.79÷.98) | 8÷10 (.31÷.39) | 2,5÷10 (.1÷.39) |
| Max. allowable speed | m/s (ft/s) | 32 (105) | 50 (164) | 80 (262.5) | 80 (262.5) |
| Grinder-Ø d1/d2 | mm (in) | 39/86 (1.54/3.39) | 39/86 (1.54/3.39) | 39/72 (1.54/2.83) | 39/86 (1.54/3.39) |
| Grinder length L | mm (in) | 564 (22.20) | 545 (21.46) | 506 (19.92) 511 (20.12) | 513 (20.20) |
| Air connection | | thread 1/2" female | thread 1/2" female | thread 1/2" female | thread 1/2" female |
| Weight | kg (lbs) | 6,5 (14.33) | 5,4 (11.90) | 4,0 (8.82) 4,25 (9.37) | 5,5 (12.13) |

Specifications at 90 psi (6,3 bar)

* With Autobalancer for reduced vibrations

| Standard Equipment: | Part Number | | | |
|--|-------------|---------|---------|---------|
| Allen key 2 mm | - | 800443 | 800443 | 800443 |
| Allen key 4 mm (for design E, with autobalancer) | - | - | 800447 | 800447 |
| Allen key 6 mm | 800449 | 800449 | 800449 | 800449 |
| Hose nozzle G1/2" | 6013767 | 6013767 | 6013767 | 6013767 |
| O ring | 802517 | 802517 | 802517 | 802517 |
| T wrench (for design E, with autobalancer) | - | - | 828832 | 828832 |

| Optional Accessories: | Part Number | | | |
|--------------------------------------|-------------|---------|---------|---------|
| Swivel connector G1/2" | 6078628 | 6078628 | 6078628 | 6078628 |
| Nipple | 6072227 | 6072227 | 6072227 | 6072227 |
| Hose nozzle G1/2" | 6021377 | 6021377 | 6021377 | 6021377 |
| Hose set (hose LW 13 mm, length 4 m) | 315130A | 315130A | 315130A | 315130A |

Optional Accessories:

Swivel connector G1/2"
Part No. 6078628

The swivel is an ingenious multi-directional connector. Connect your tool and the hose will stay in ideal position however much you and the tool move around. It takes the effort out of working in those cramped spaces. The hose feels almost weightless and it reduces hose wear.



Set - hose 4 m, connection
Part No. 315130A



DEPRAG
machines unlimited



DEPRAG CZ a.s., T. G. Masaryka 113, 507 81 Lázně Bělohrad - Czech Republic
Tel.: +420-493 771 511, Fax: +420-493 771 623, E-mail: sales@deprag.cz, Internet: www.deprag.cz

Specifications subject to change without prior notice